



# Technical Support

## *1967 Speed Control Installation Instructions*

The following pages include the scanned instructions sheets from a 1967 NOS dealer installation kit for speed (cruise) control. There were at least two suppliers of these systems to Ford that year, believe this one was the Bendix variety.

Illustrations have been rearranged to fit these pages since the originals ranged from 8 1/2 x 11" to 17 x 11" but care was taken to include all the notes and illustrations contained within those original pages.

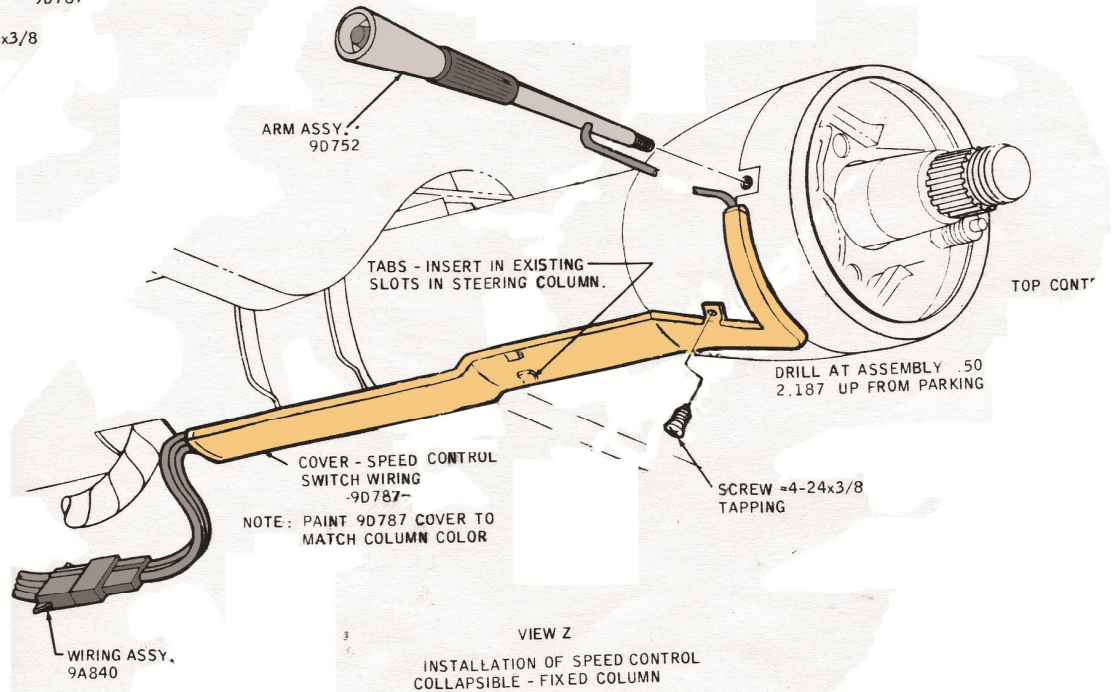
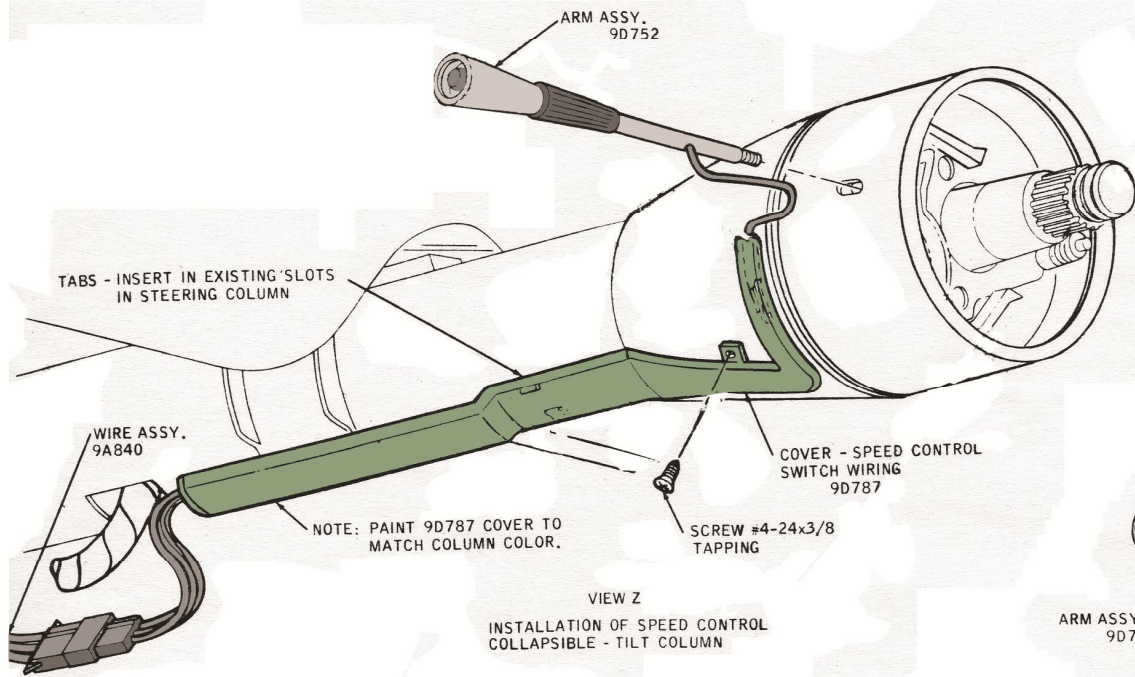

1967 MUSTANG

I.S. 2627	SHEET 1 OF 7
INSTALLATION - KIT - CONTROL SPEED	



COPYRIGHT © 1967 FORD MOTOR COMPANY DEARBORN, MICHIGAN



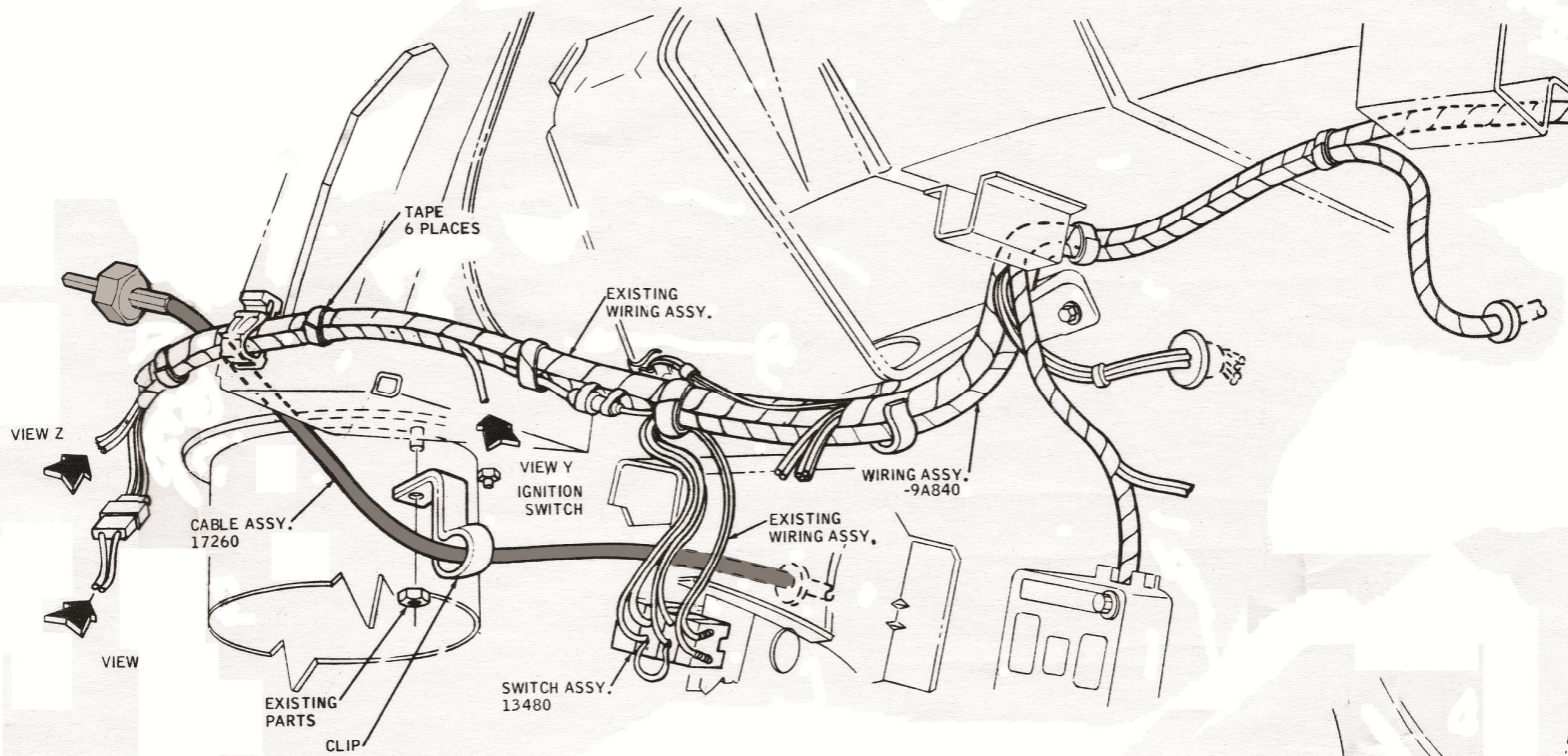

NOTE:

1. INSTALL 9D752 LEVER UNTIL 20-24 LB. IN. IS OBTAINED.
2. CONTINUE TO ROTATE LEVER UNTIL WIRES EXISTING FROM LEVER ARE PROPERLY ORIENTATED (WIRES EXTEND DOWNWARD ON COLUMN CENTERLINE)
3. DO NOT INSTALL LEVER ASSY. BY APPLYING TORQUE TO KNOBS.

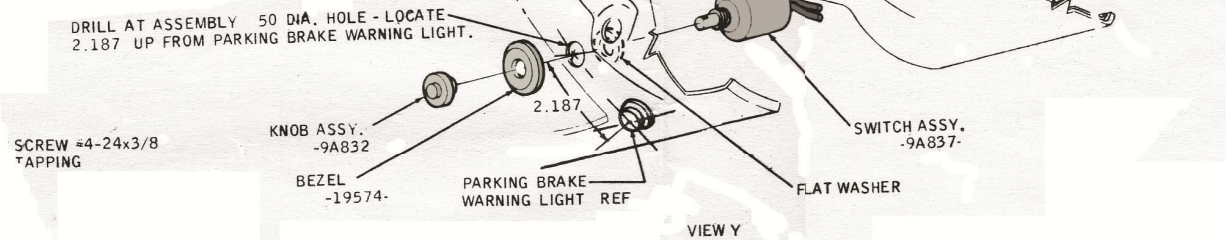

1967 MUSTANG

I.S. 2627	SHEET 1b OF 7
INSTALLATION - KIT - CONTROL SPEED	





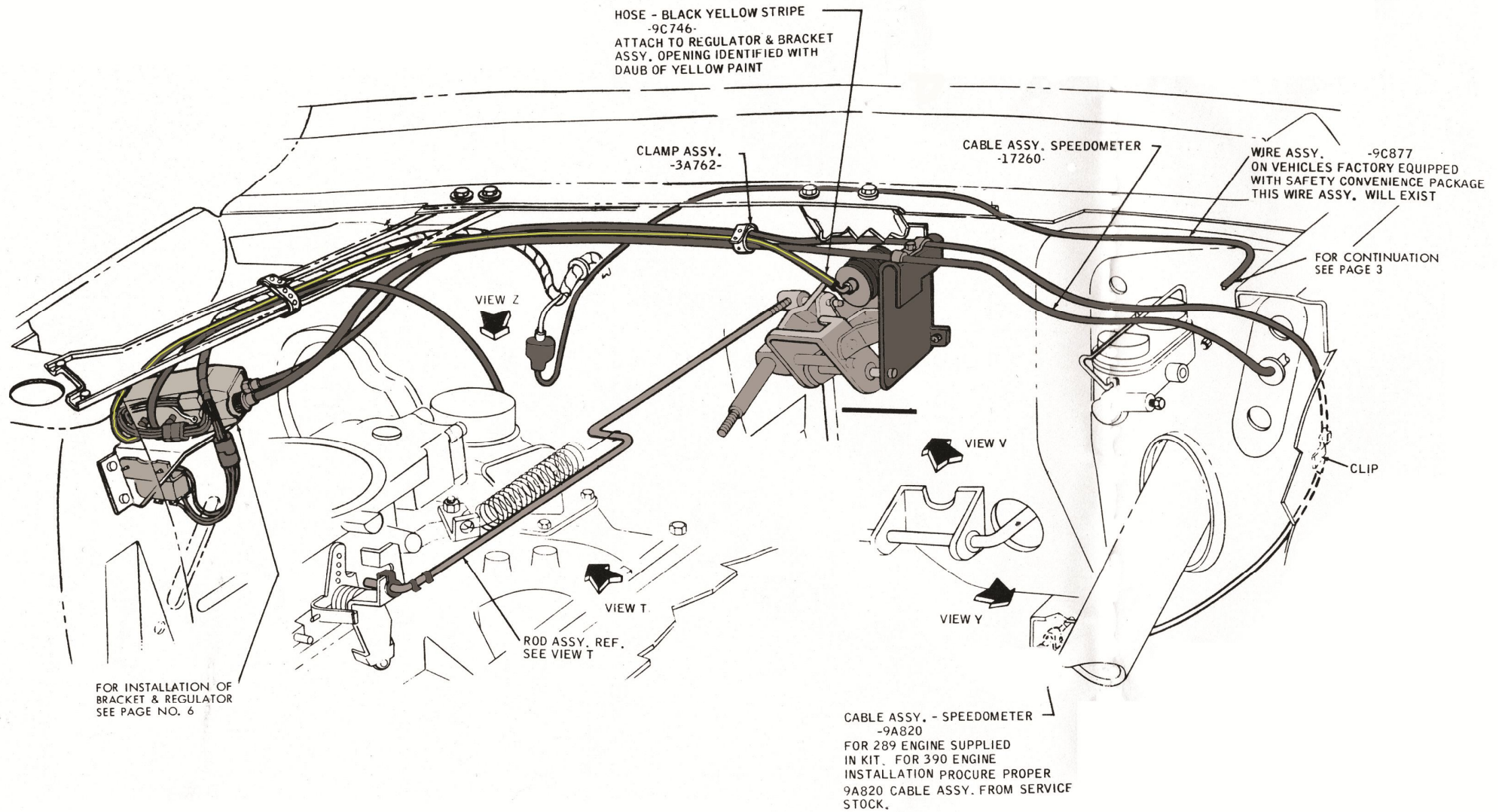

1967 MUSTANG

I.S. 2627	SHEET 2a OF 7
INSTALLATION - KIT - CONTROL SPEED	

  
 COPYRIGHT © 1967 FORD MOTOR COMPANY  
 DEARBORN, MICHIGAN



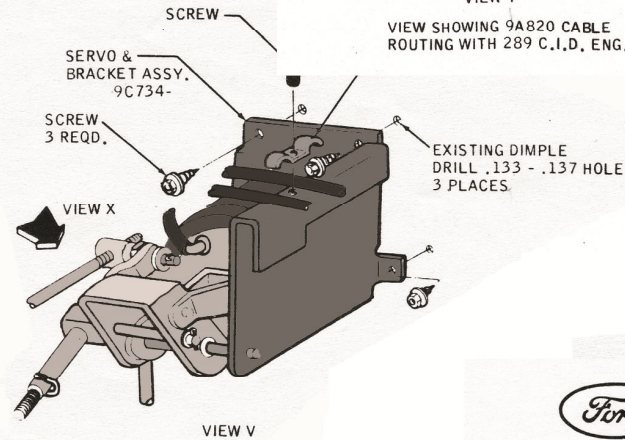
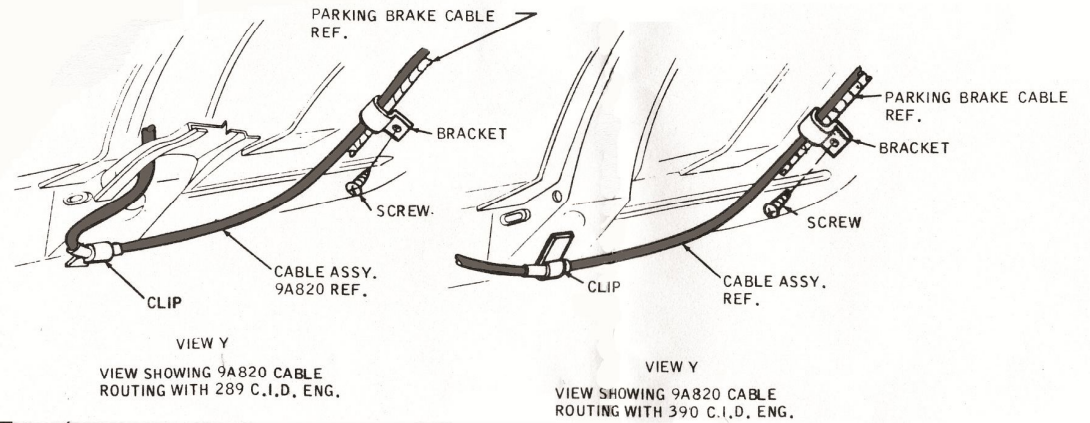
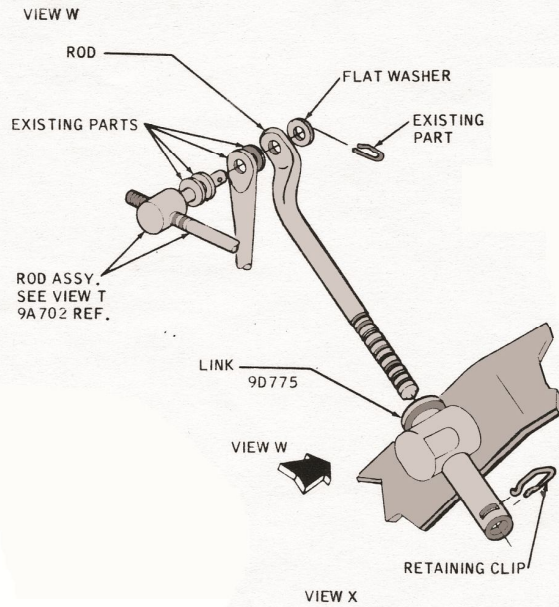
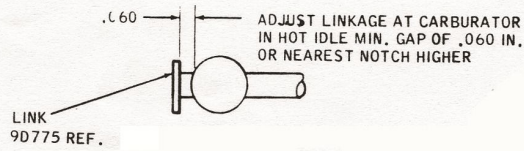
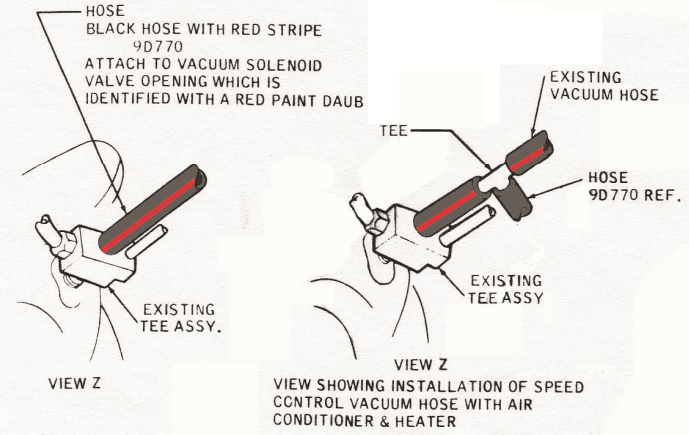
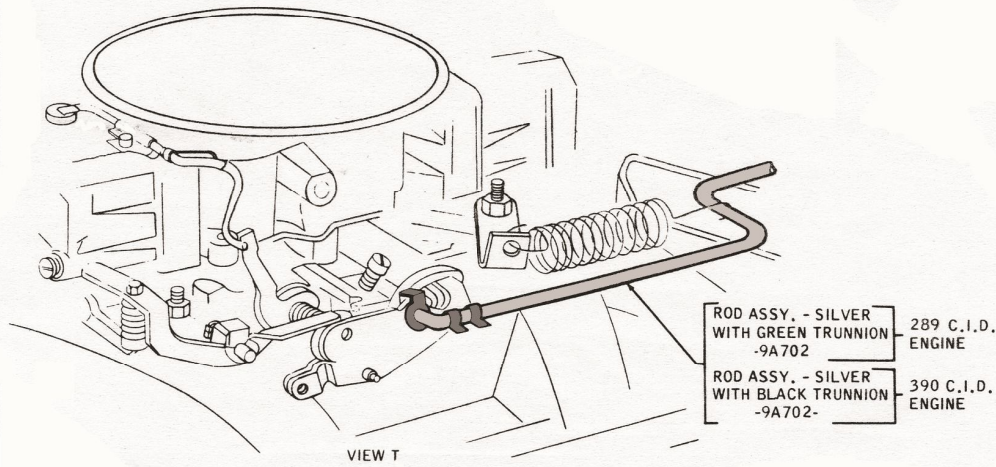

  
 COPYRIGHT © 1967 FORD MOTOR COMPANY  
 DEARBORN, MICHIGAN

1967 MUSTANG

I.S. 2627	SHEET 2b OF 7
INSTALLATION - KIT - CONTROL SPEED	

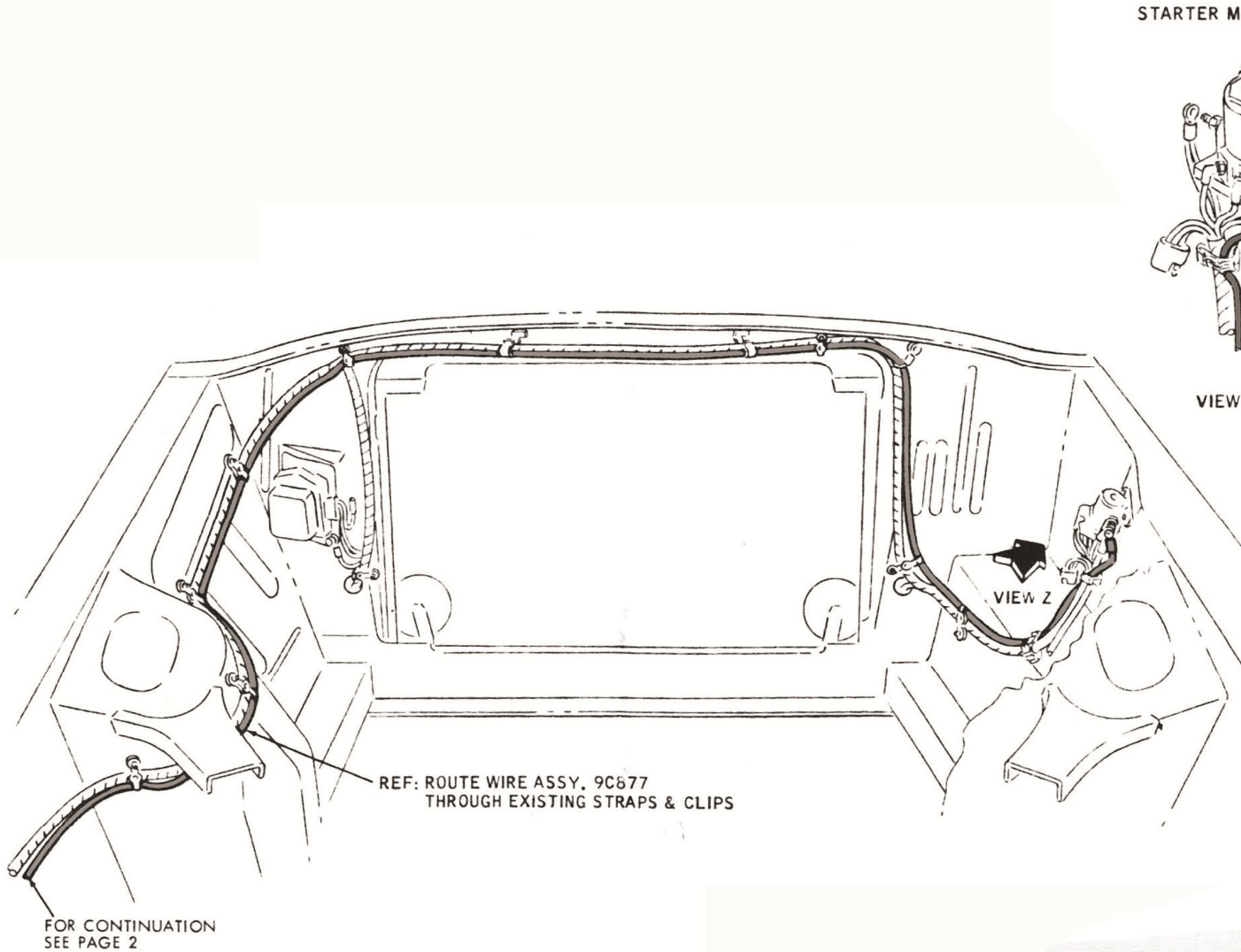

STARTER MOTOR RELAY

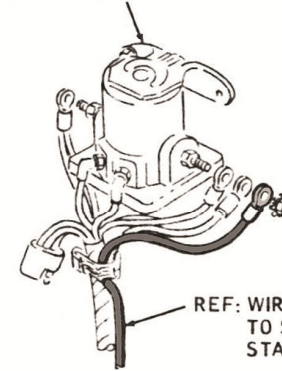

VIEW Z

REF: WIRE ASSY. 9C877 MUST BE SECURED TO STARTER MOTOR SIDE OF STARTER MOTOR RELAY

VIEW Z

REF: ROUTE WIRE ASSY. 9C677 THROUGH EXISTING STRAPS & CLIPS

FOR CONTINUATION SEE PAGE 2

1967 MUSTANG

I.S. 2627

SHEET 3 OF 7



COPYRIGHT © 1967 FORD MOTOR COMPANY DEARBORN, MICHIGAN

INSTALLATION - KIT - CONTROL SPEED



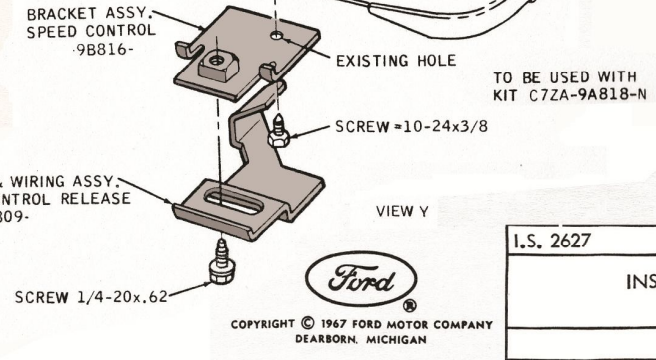
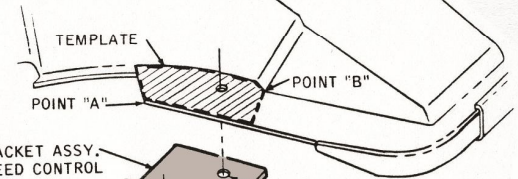
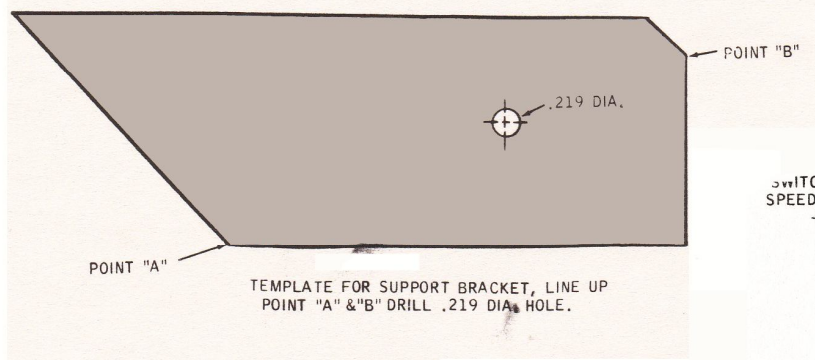
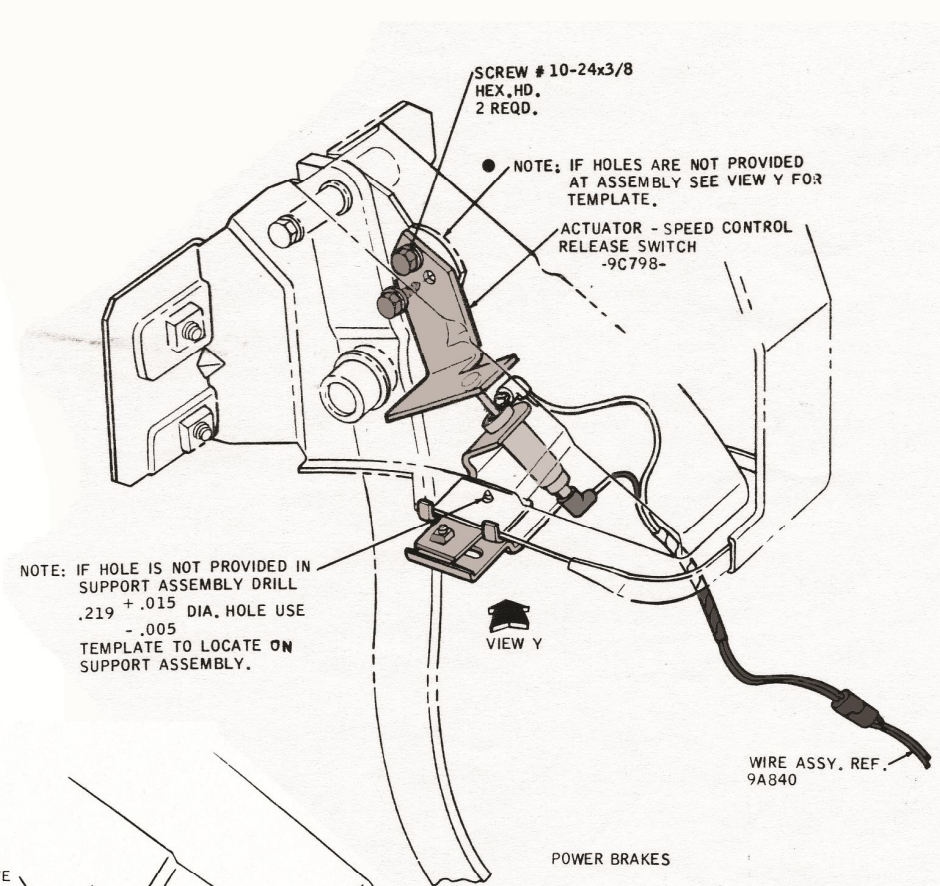
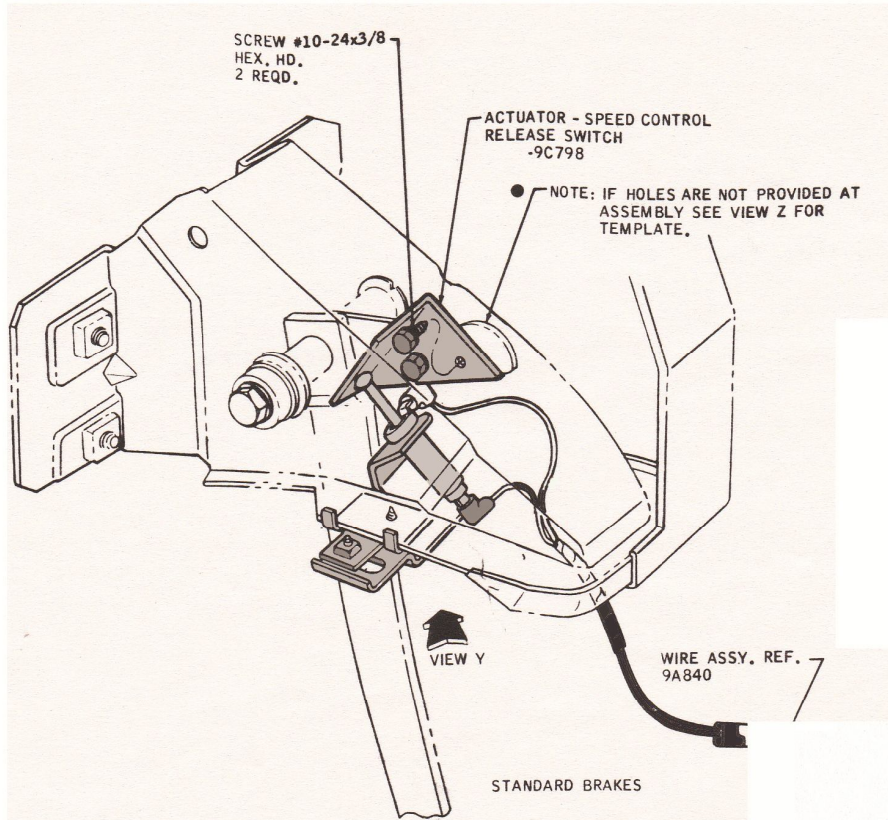

COPYRIGHT © 1967 FORD MOTOR COMPANY  
DEARBORN, MICHIGAN

I.S. 2627	1967 MUSTANG	SHEET 4a OF 7
INSTALLATION - KIT - CONTROL SPEED		

Some documents & illustrations have been altered or rearranged from their original configuration or in size to fit the format. No information was deleted or altered in the process.

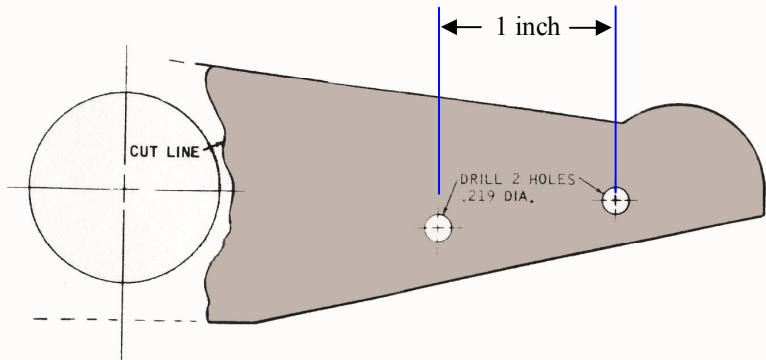

VIEW Z  
TEMPLATE FOR STANDARD BRAKES

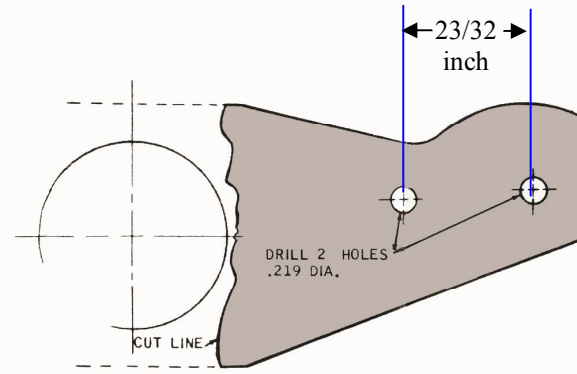

VIEW Y  
TEMPLATE FOR POWER BRAKES

● NOTE: WHEN HOLES ARE NOT IN BRAKE PEDAL ARM THE BRAKE PEDAL ARM IS TO BE REMOVED. (REF. SHOP MANUAL INSTRUCTIONS) DRILL HOLES PER TEMPLATE "Y" OR "Z" AND REINSTALL WITH ACTUATOR ATTACH.

 COPYRIGHT © 1967 FORD MOTOR COMPANY DEARBORN, MICHIGAN	1967 MUSTANG	
	I.S. 2627	SHEET 4b OF 7
	INSTALLATION - KIT - CONTROL SPEED	



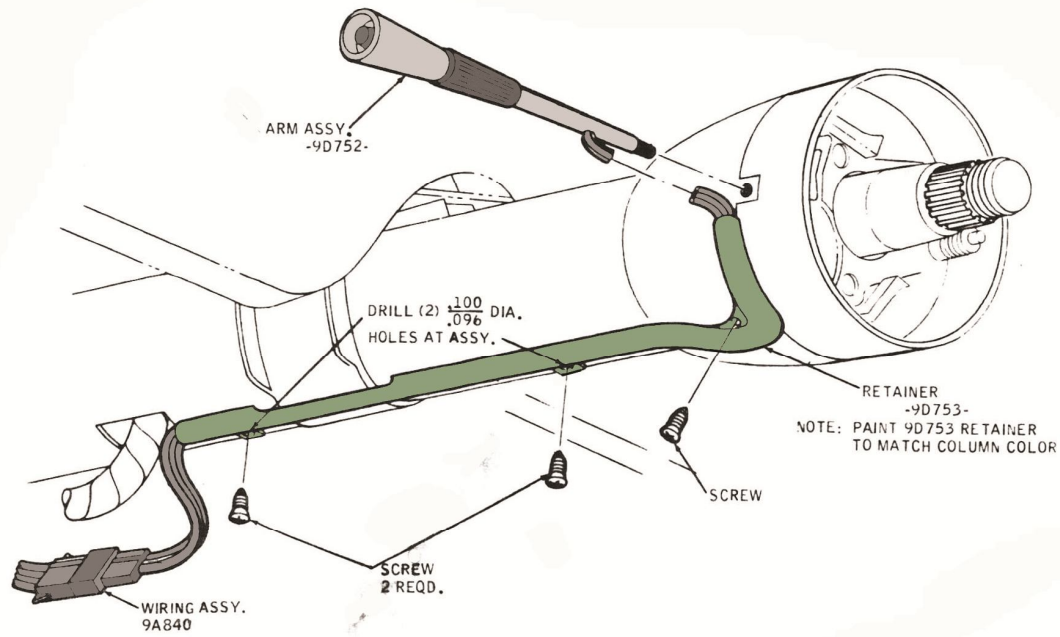

INSTALLATION OF SPEED CONTROL ON FIXED COLUMN  
NON-COLLAPSIBLE

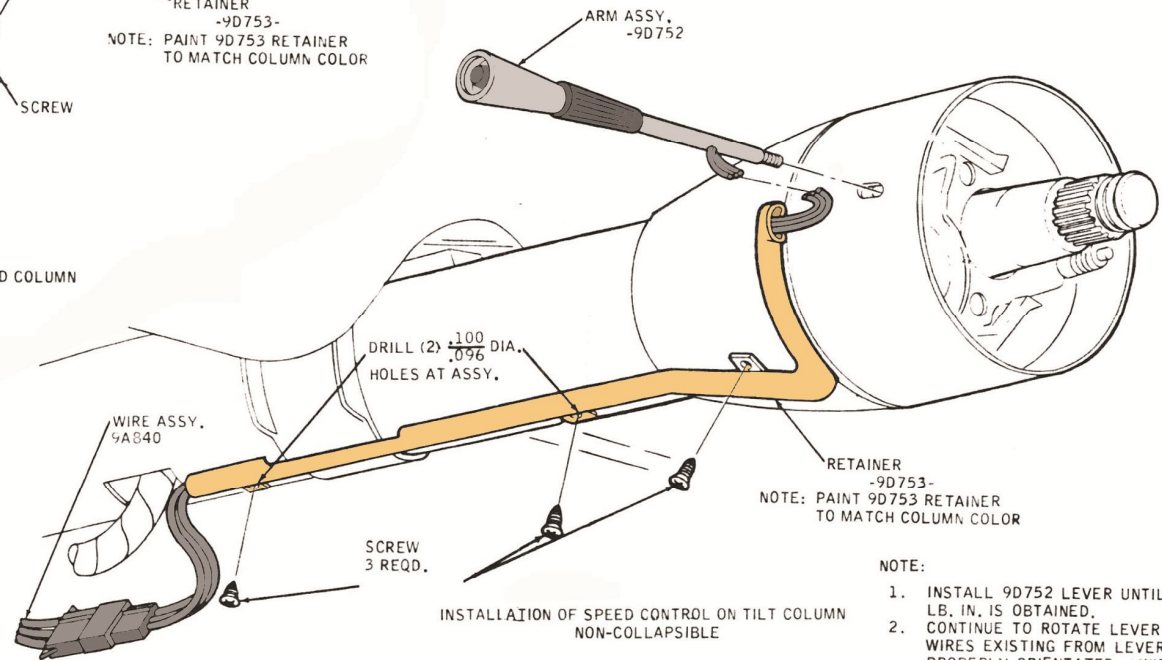

INSTALLATION OF SPEED CONTROL ON TILT COLUMN  
NON-COLLAPSIBLE

- NOTE:
1. INSTALL 9D752 LEVER UNTIL 20-24 LB. IN. IS OBTAINED.
  2. CONTINUE TO ROTATE LEVER UNTIL WIRES EXISTING FROM LEVER ARE PROPERLY ORIENTATED (WIRES EXTEND DOWNWARD ON COLUMN CENTERLINE.)
  3. DO NOT INSTALL LEVER ASSEMBLY BY APPLYING TORQUE TO KNOBS.



I.S. 2627	1967 MUSTANG	SHEET 5 OF 7
INSTALLATION - KIT - CONTROL SPEED		

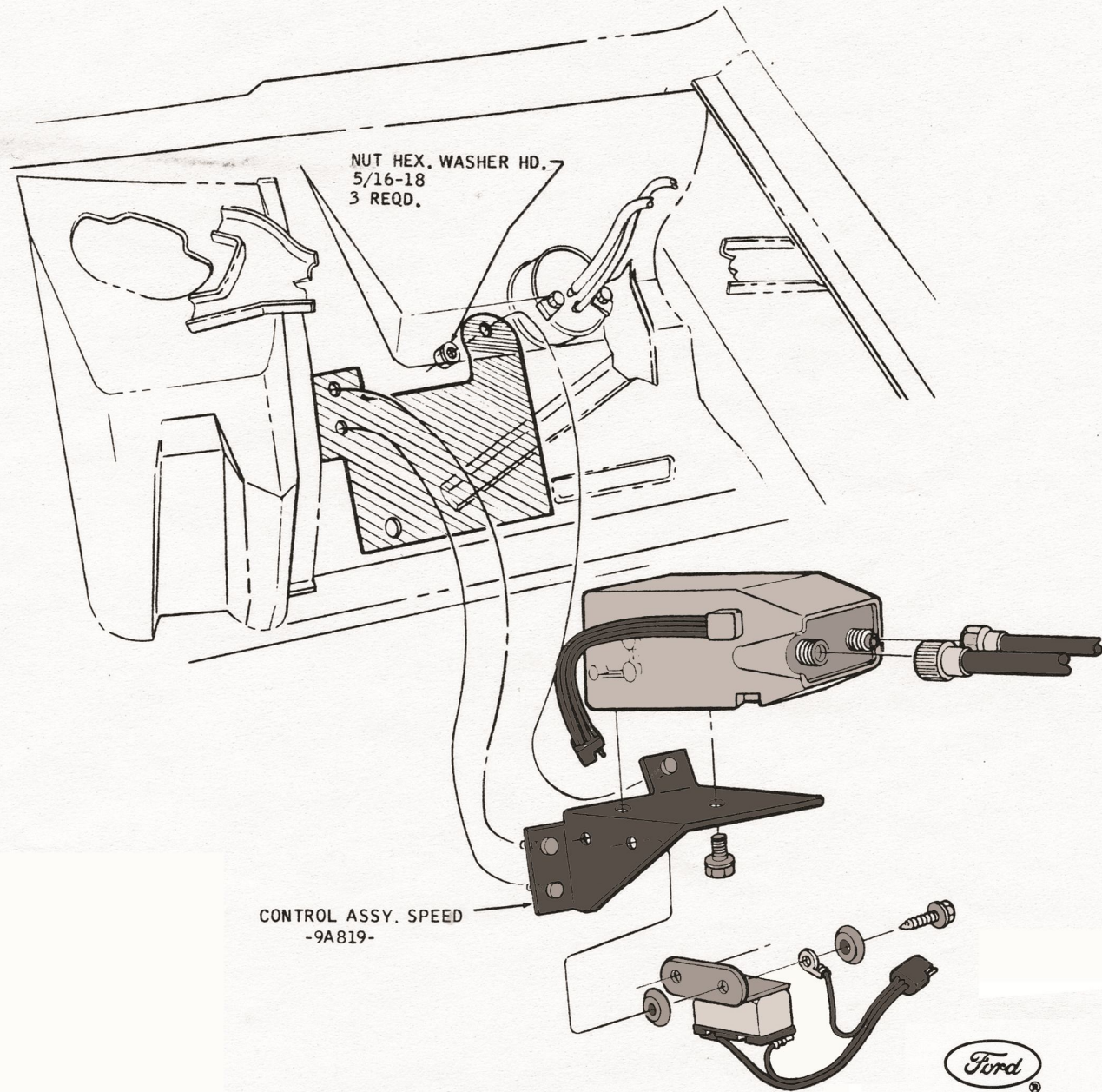

NUT HEX. WASHER HD.  
5/16-18  
3 REQD.

CONTROL ASSY. SPEED  
-9A819-

  
COPYRIGHT © 1967 FORD MOTOR COMPANY  
DEARBORN, MICHIGAN

I.S. 2627	1967 MUSTANG	SHEET 6a OF 7
INSTALLATION - KIT - CONTROL SPEED		

Some documents & illustrations have been altered or rearranged from their original configuration or in size to fit the format. No information was deleted or altered in the process.



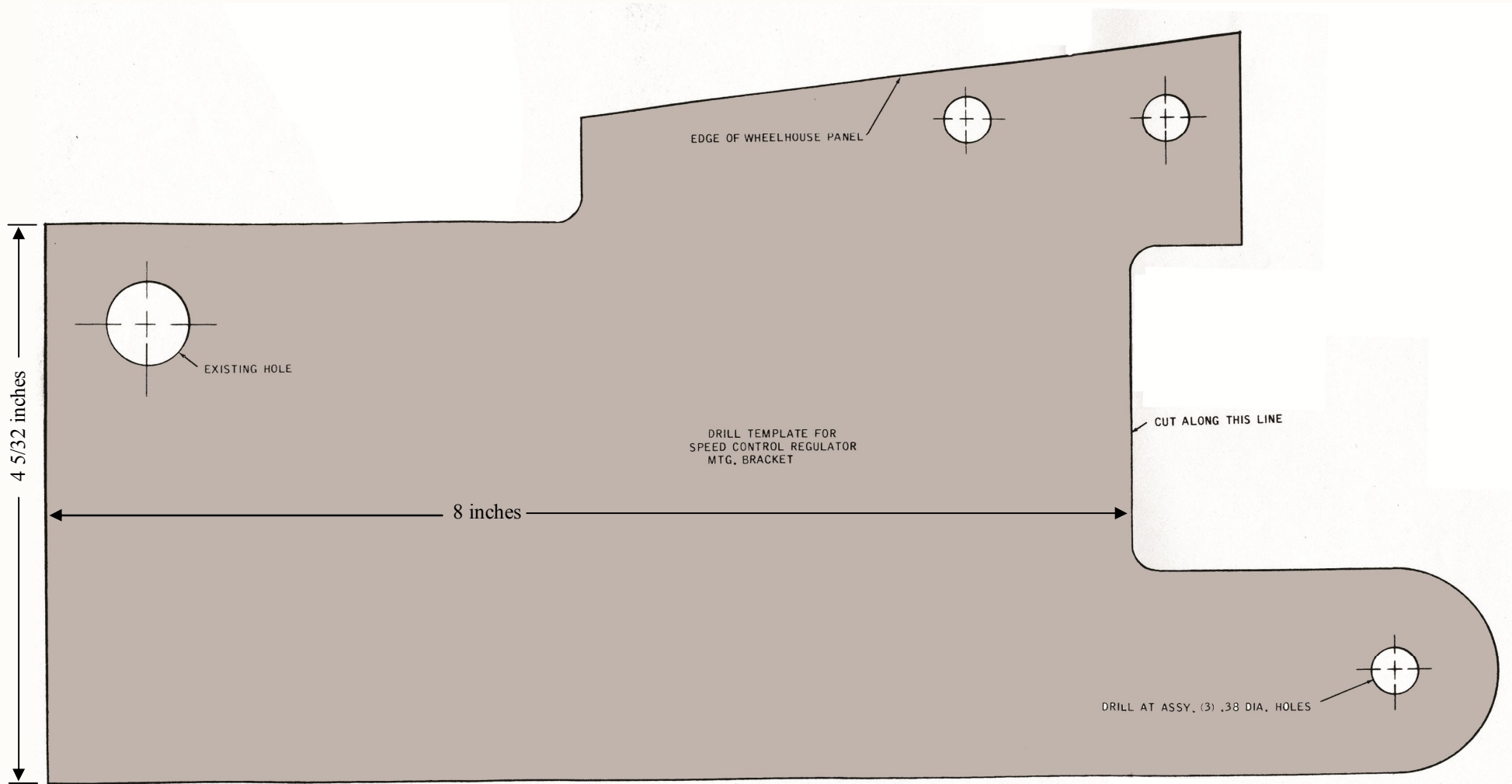

1967 MUSTANG	
I.S. 2627	SHEET 6b OF 7
INSTALLATION - KIT - CONTROL SPEED	

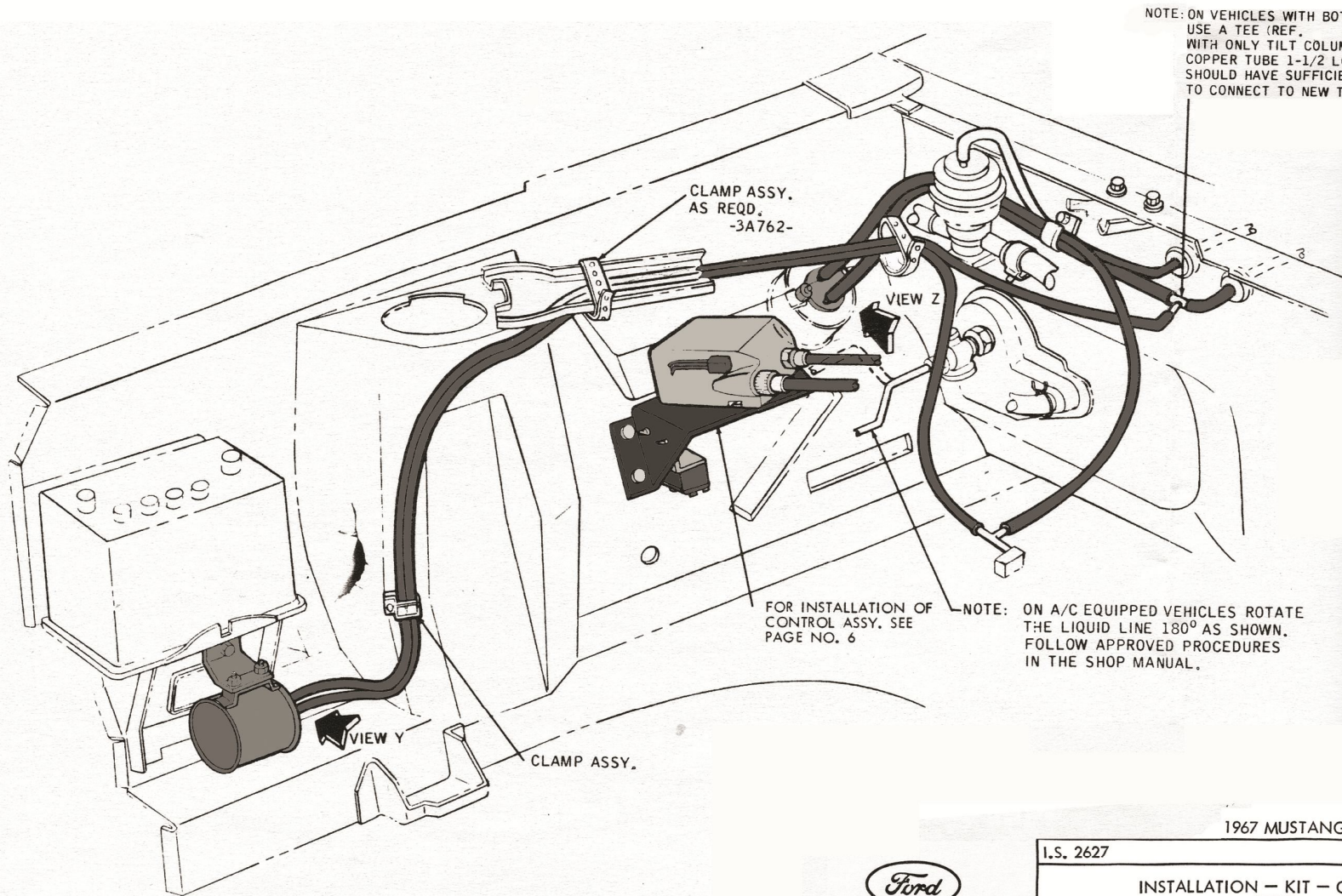

1967 MUSTANG

I.S. 2627

SHEET 7a OF 7

INSTALLATION - KIT - CONTROL SPEED



COPYRIGHT © 1967 FORD MOTOR COMPANY DEARBORN, MICHIGAN



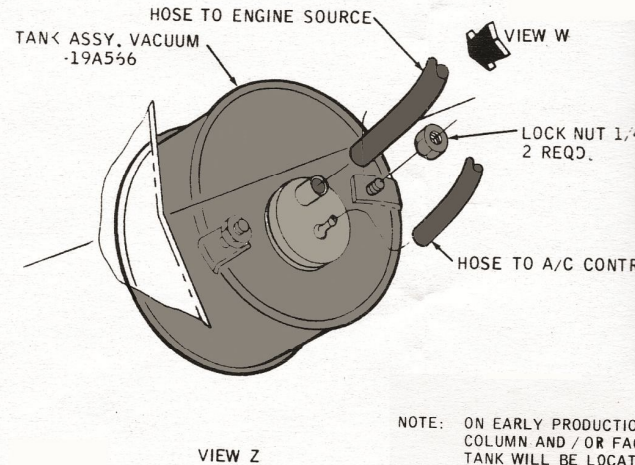
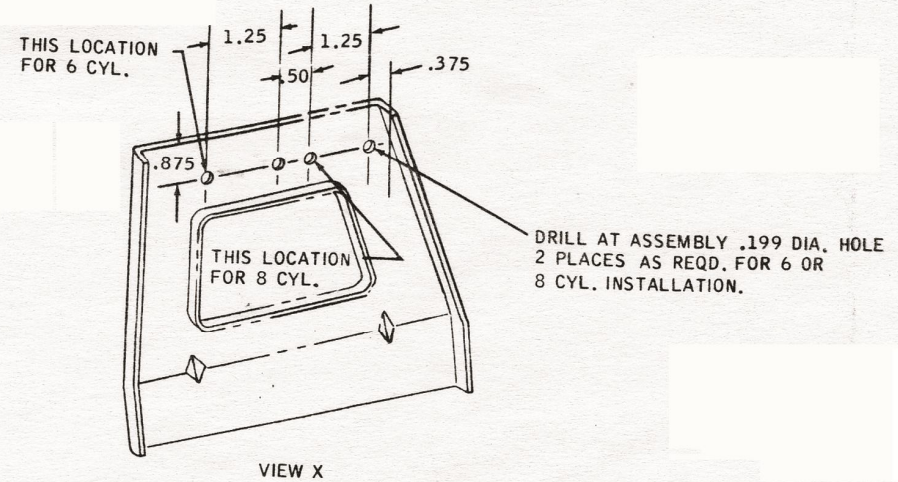
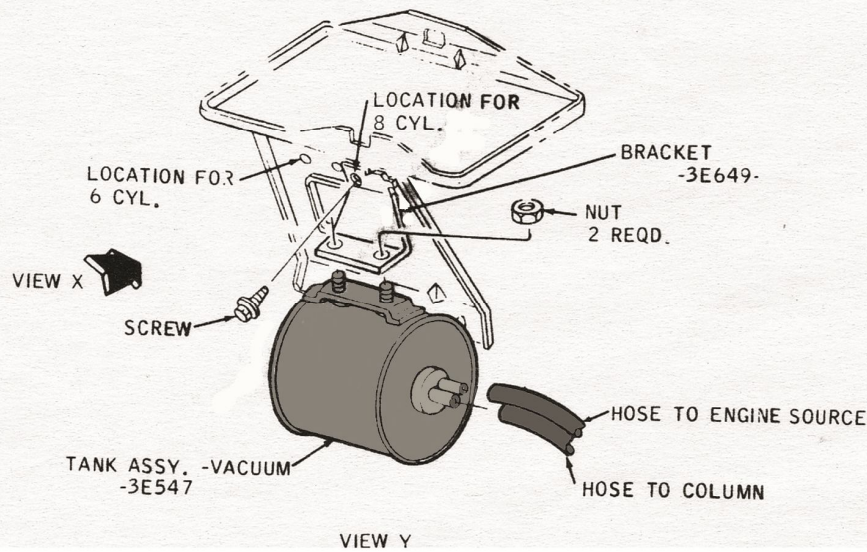

NOTE: ON EARLY PRODUCTION VEHICLES EQUIPPED WITH EITHER TILT COLUMN AND / OR FACTORY INSTALLED AIRCONDITIONING A VACUUM TANK WILL BE LOCATED ON THE RIGHT HAND APRON WHERE THE SPEED CONTROL ASSEMBLY IS TO BE INSTALLED. THIS TANK WILL HAVE TO BE REMOVED AND ONE OR TWO NEW TANKS INSTALLED AS SHOWN. ON A/C VEHICLES THE LIQUID LINE WILL ALSO HAVE TO BE ROTATED AS SHOWN.

NOTE: TEMPLATE SHOWN PART OF SPEED CONTROL BRACKET ASSEMBLY INSTALLATION AS SHOWN ON PAGE 6

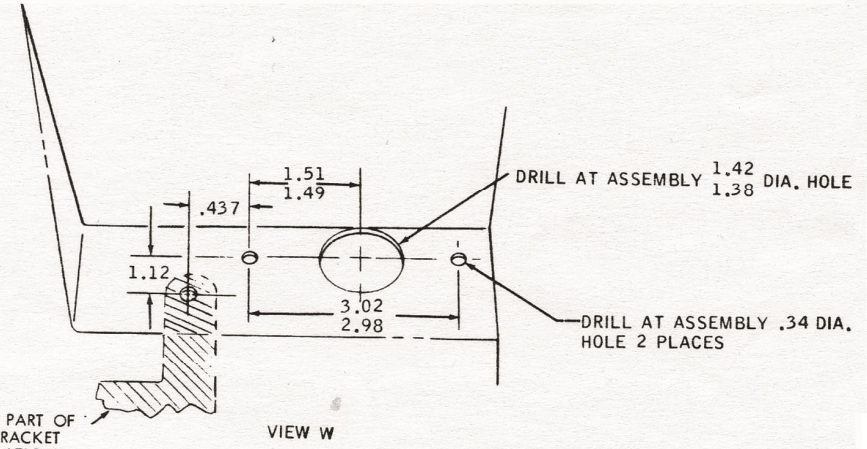

COPYRIGHT © 1967 FORD MOTOR COMPANY DEARBORN, MICHIGAN

I.S. 2627	1967 MUSTANG	SHEET 7b OF 7
INSTALLATION - KIT - CONTROL SPEED		

Kit Number C7ZZ-9A818-B

March 7, 1967

ADDENDUM TO I.S. NO. 2627

Note on Sheet No. 7 of 7 should be clarified as follows:

On early production vehicles equipped with tilt column, procure bracket C7ZZ-3F547-A and relocate tank as shown. On factory air conditioning equipped vehicles, procure tank assembly C7ZZ-19A566-A and install as shown. On vehicles with both air conditioning and tilt column, procure both tank assemblies C7ZZ-19A566-A and C7ZZ-3E547-A and bracket C7ZZ-3F547-A and install as shown. Also on 390 engine installations, check tank installation under battery tray to insure clearance to engine.

Add to Sheet No. 6 of 7:

Check speed control assembly after installation for clearance to hood hinge. Body variations may require lowering of assembly.



## Additional Graphics From Other Period Resources

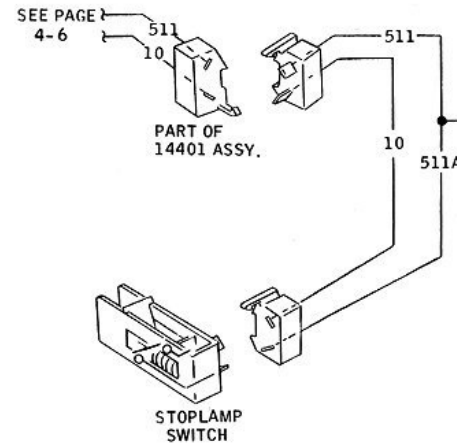
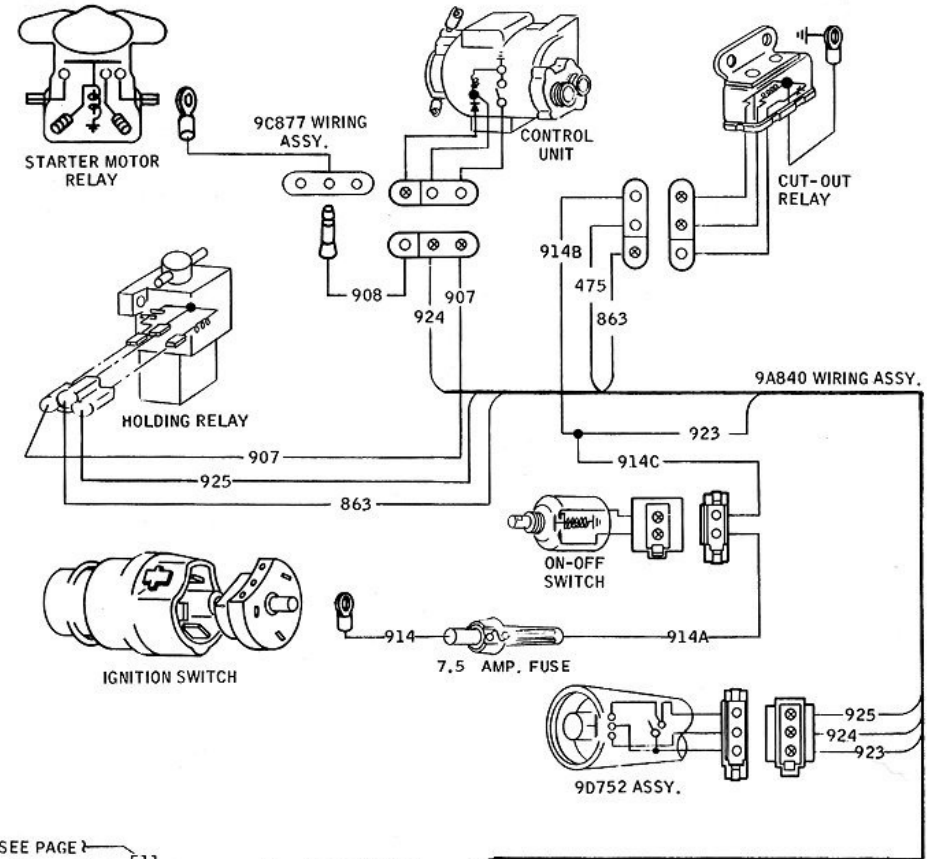
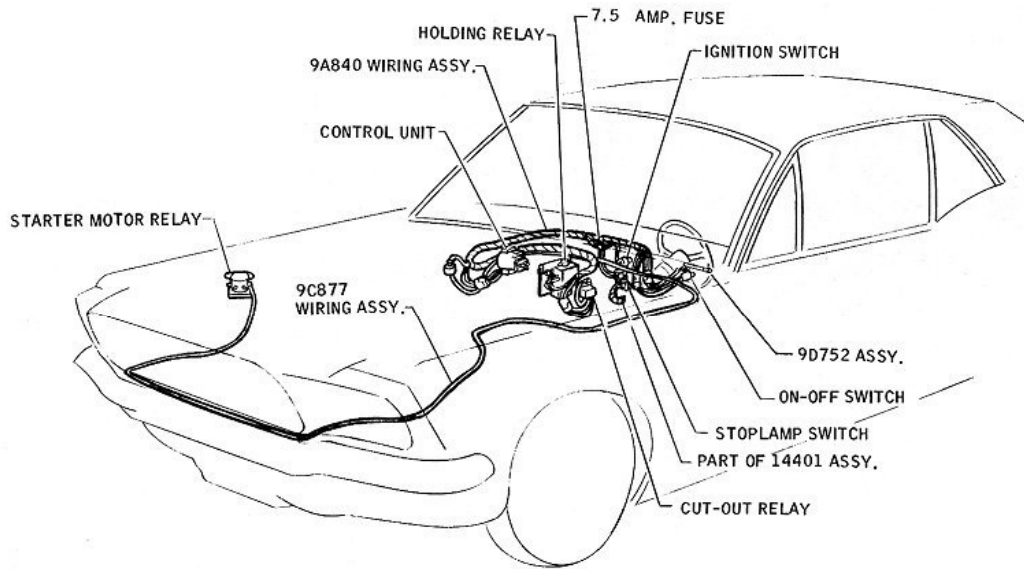

WIRING COLOR CODE

10	GREEN-RED STRIPE
475	GREEN-WHITE STRIPE
511	GREEN
511A	GREEN
863	BLACK-YELLOW STRIPE
907	BLACK-ORANGE STRIPE
908	YELLOW
914	GREEN
914C	VIOLET
914B	VIOLET
914A	VIOLET
923	VIOLET
924	RED
925	WHITE

## 1967 MUSTANG SPEED CONTROL

# Additional Graphics From Other Period Resources

